



© Automobili Lamborghini S.p.A.

The information and procedures published below are strictly confidential and exclusively for the Lamborghini Dealer Network and Authorized Service Points. All copyrights are property of Automobili Lamborghini S.p.A based on copyright law. All of the PDF chapters in the WEB workshop manuals described below are based on information available at the time of publication. The company reserves the right to make updates and modifications. The following are prohibited: reprinting, reproduction, forwarding to unauthorized people and/or third parties, and translation, including partial, without written authorization from Automobili Lamborghini S.p.A.



Rear ride height

STOP Check the rear tire proper inflation.

Adjust operating on the shock absorber ring nut and counter ring nut (**A-Fig.1**).

STOP Carry out the check and adjustment on both sides of the vehicle.

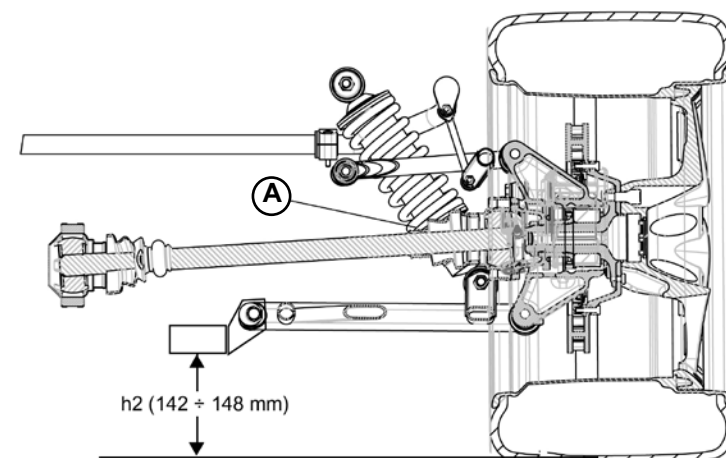

44_15
Fig.1



® Automobili Lamborghini S.p.A.

The information and procedures published below are strictly confidential and exclusively for the Lamborghini Dealer Network and Authorized Service Points. All copyrights are property of Automobili Lamborghini S.p.A based on copyright law. All of the PDF chapters in the WEB workshop manuals described below are based on information available at the time of publication. The company reserves the right to make updates and modifications. The following are prohibited: reprinting, reproduction, forwarding to unauthorized people and/or third parties, and translation, including partial, without written authorization from Automobili Lamborghini S.p.A.

Equipment assembly on the wheels

Use equipment available on the market (the one shown in the figure has illustration purposes only).



Take care not to damage the vehicle rims.



Fig.2



© Automobili Lamborghini S.p.A.

The information and procedures published below are strictly confidential and exclusively for the Lamborghini Dealer Network and Authorized Service Points. All copyrights are property of Automobili Lamborghini S.p.A based on copyright law. All of the PDF chapters in the WEB workshop manuals described below are based on information available at the time of publication. The company reserves the right to make updates and modifications. The following are prohibited: reprinting, reproduction, forwarding to unauthorized people and/or third parties, and translation, including partial, without written authorization from Automobili Lamborghini S.p.A.

Camber (rear)

STOP Measure must be taken after the check (and adjustment, if necessary) from the rear ride height (H- Fig.3).

Adjust operating on cam pins (A-Fig.3).

STOP Carry out the check and adjustment on both sides of the vehicle.

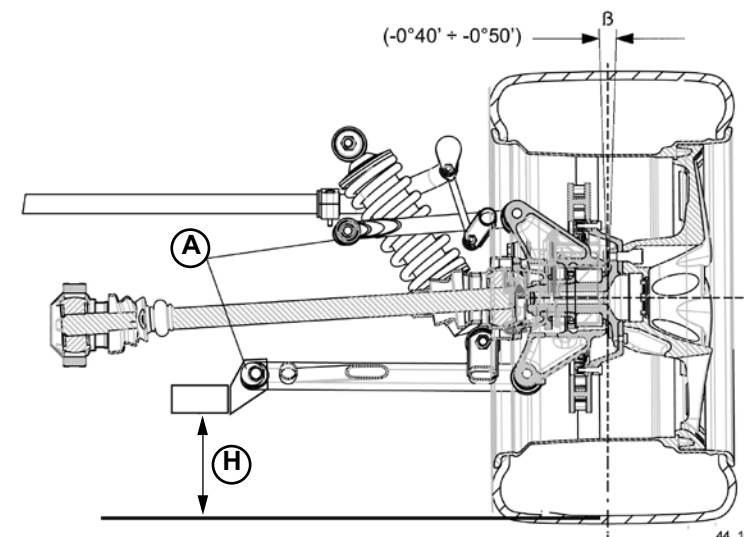

Fig.3



© Automobili Lamborghini S.p.A.

The information and procedures published below are strictly confidential and exclusively for the Lamborghini Dealer Network and Authorized Service Points. All copyrights are property of Automobili Lamborghini S.p.A based on copyright law. All of the PDF chapters in the WEB workshop manuals described below are based on information available at the time of publication. The company reserves the right to make updates and modifications. The following are prohibited: reprinting, reproduction, forwarding to unauthorized people and/or third parties, and translation, including partial, without written authorization from Automobili Lamborghini S.p.A.

Rear wheel toe-in

Adjust operating on the cam pins (**A-Fig.4**) to reach the specified D measure.

The indicated values are related to one wheel only.



Carry out the check and adjustment on both sides of the vehicle.

The total value must be $0^{\circ}20' \div 0^{\circ}28'$.

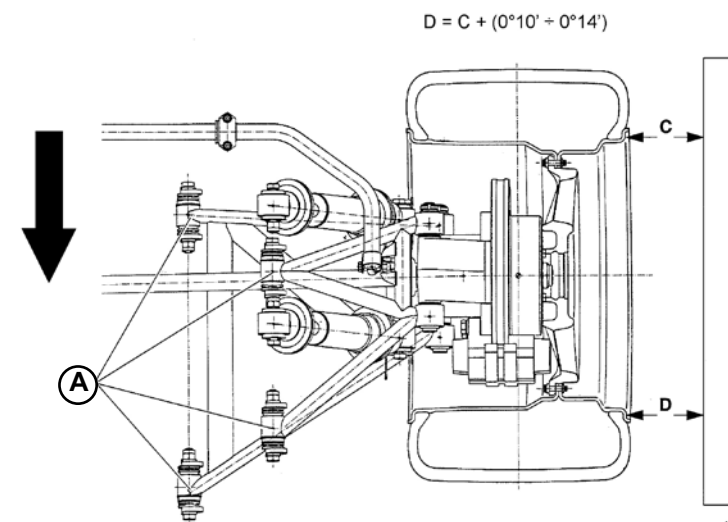

44_17

Fig.4

**® Automobili Lamborghini S.p.A.**

The information and procedures published below are strictly confidential and exclusively for the Lamborghini Dealer Network and Authorized Service Points. All copyrights are property of Automobili Lamborghini S.p.A based on copyright law. All of the PDF chapters in the WEB workshop manuals described below are based on information available at the time of publication. The company reserves the right to make updates and modifications. The following are prohibited: reprinting, reproduction, forwarding to unauthorized people and/or third parties, and translation, including partial, without written authorization from Automobili Lamborghini S.p.A.

Rear misalignment (Fig.5)

A. Adjustment shim SP



The adjustment shims SP are only to be used to adjust the caster.

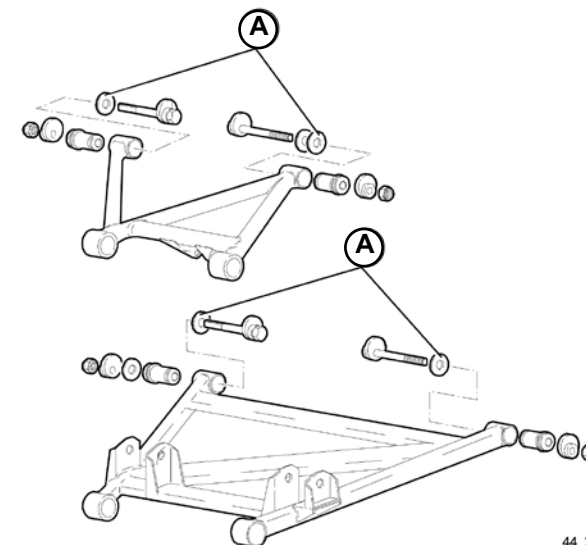

44_22 Fig.5